

4/RECOMMENDED USAGE

Casting

· All FISHSTONE assemblies using the FIX latex-strap are castable.

CAUTION: Assemblies with SLIP are NOT castable!

· Use smooth casting technique (ideally overhead, swing or side-ways)

· SNÄP is not designed for vigorous long-distance casts (up to 80m)

· Brake / stop the line before your cast hits the water surface to stretch the whole assembly

· In general, the tangle risk enhances with increasing weight and non-roundness of the selected stone

· Take preventative measures as with conventional assemblies (e.g. anti-tangle-boom, PVA bag, stiff rig, helicopter rig)

Sinking Phase

· Let it drop in a controlled manner on a tensioned line

When casting:

· Hold rod upright until weight touches down on the bottom

From the boat:

· Don't let it drop vertically down

· Let it sink of to the side of the rod

· Let it drop in a controlled manner

Reeling in

· SLIP-systems also allow the release of the DROP-OFF even without a bite before reeling in – just give it one or two decent jigs

· FIX and SNÄP-systems require a quick and continuous pull in on a upright rod, to prevent the assembly from catching on the bottom

ASSEMBLING INSTRUCTION

FOR FISHSTONE PRODUCTS

Dear Fishing Buddy,

thank you for purchasing one of our FISHSTONE products and for supporting sustainable fishing. We welcome you to the world of "stone-fishing". We wish you lots of joy and unforgettable fishing adventures!

Your FISHSTONE Team

Karsten Jaszkowiak



FISHSTONE
THE FISHY FISHING STONE

5/SAFETY INSTRUCTIONS AND 6/STORAGE

5. Safety instructions

Check before each cast:

1. Is the SNÄP coupling still tight (warranted for a minimum of 100 open/close actions, provided that it is used appropriately, excluding other damage) **(SNÄP only)**

2. Is the latex-strap FIX or SLIP free from cracks? Cracks are easy to identify when stretching the latex.

↪ If at least one of the above questions is answered with "no", we recommend to replace the affected worn part. (ein Hindernis stellen)

· When casting, others should not stand within the casting area (ideally behind an obstacle)

· Follow the assembly instructions (4) and the recommended usage (5) instructions

· Check maximum casting weight of your fishing rod

· Keep small parts away from small children

6. Storage

· FIX and SLIP are made of natural latex (natural caoutchouc) – store it dry and in the shade!

· SNÄP, ZIP and LOOP-bodies consist of biodegradable polylactide (PLA) – thermally stable up to 50°C

· Open SNÄP coupling when storing it to prevent material deformation



Storage of SNÄP:

- do not expose to sun
- open SNÄP coupling when storing it to prevent material deformation

1/FISHSTONE VOCABULARY

DROP-OFF-System

· System to intentionally release the fishing weight as a result of a bite or under particular conditions

SNĀP-System

castable DROP-OFF-System
· comes with FIX latex-straps
· Snap coupling opens up when fish is hooked
· drops the stone sinker at a specific release point

SLIP-Systems

(droppable DROP-OFF-System
· LOOP or ZIP in combination with SLIP latex-straps.
· Not castable! Only droppable (e.g. from boat)
· Stone weight releases due to sudden tension on the line (fish bite or a few stronger jig movements)

FIX-Systems

· Use FIX latex-straps to make LOOP, ZIP and SNĀP castable
· DROP-OFF function only in combination with SNĀP

FIX latex strap

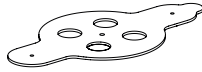

LOOP body



ZIP body

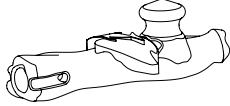

pearl



clip



swivel



SLIP latex strap



SNĀP body

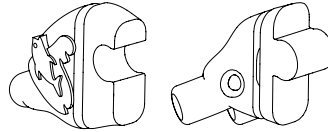

wire



2/THE WORLD OF FISHSTONE

PRODUCT AND APPLICATION RANGE

Our FISHSTONE products are built upon a flexible modular design principle. Through various combinations of the individual elements, a wide variety of applications can be realised.

The elastic latex straps FIX and SLIP allow arbitrary objects to be used in your rig, such as a simple stick as a spot marker, or attaching an additional weight as a sinker.

On the right, various example applications areas of our products are listed. However, there are certainly further ways how and where the products can be used - limited only by your imagination!

For more information and inspiration, watch our product videos: www.fishstone.de/products

Usage/Features	SNĀP	ZIP	LOOP
Stone sinker < 500 g		x	x
100g < stone fishing weight < 250 g	x		
Drop-Off	x	x	x
· Landing fish without a sinker			
· Less fish that get away	SNĀP-System (castable)	SLIP-System (droppable)	SLIP-System (droppable)
· Direct line feedback			
· fewer snags			
defined release point for sinker drop-off	x		
Fix-System		x	x
Black Lead			x (SLIP & FIX)
Guide pulley			x (SLIP & FIX)
Spotmarker		x	x
Float		x	x
Self-hooking rig	x	x	x
Running rig		x	x
Inline		x	
Attachable to clip			x
Fishing with random stones	x	x	x
FIX usable as additional Swinger-weight			
And many other applications			

3/ASSEMBLING

CLAMP STONE AND OFF YOU GO!

SNĀP

· Use only with FIX latex strap

· Clamp stone safely - after connecting both SNĀP bodies together, pull latex-flaps towards the SNĀP bodies to relieve the FIX edges and to enclose the stone entirely!

· Lay your fishing line securely around the stone - for extra safety you can also put the line underneath the FIX latex-strap

1 Pay attention to the stone's alignment - when sitting on the ground, the line exits should point downwards - we recommend some tests near-shore

Product video can be found at: www.fishstone.de/products/snaep

Only with FIX:

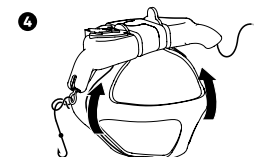
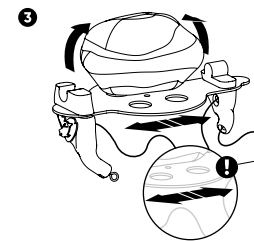
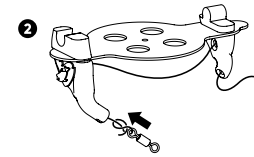
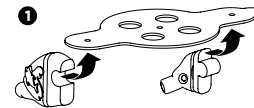

ZIP

· Use with SLIP or FIX latex-straps

· Place the ZIP body in such a way, that the stone is able to lay flat on the ground with the body fitted on its side and parallel to the ground

· For self-hooking rig, clamp the swivel in the clamp device of the body

Product video can be found at: www.fishstone.de/products/zip

Example below with SLIP:

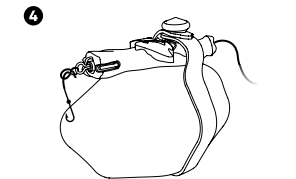
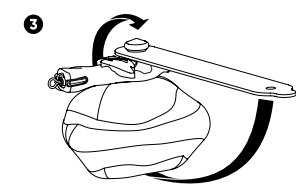
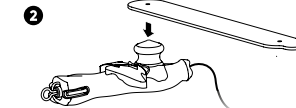
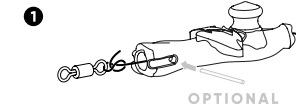

1 Notice for the assembly with FIX:

Fix the stone securely and with care! Pull latex flaps towards the body and make sure that FIX encloses the stone entirely. **When stretching the latex strap, put tension along its entire length - not only on both ends - to relieve the connecting holes!**

1 Notice for the assembly with SLIP:

DROP-OFF / SLIP release point can be influenced manually. Stone will be released under higher load / somewhat delayed when latex-strap is positioned centrally; and slips out easier when strap is attached off-center.

LOOP

· Usable with SLIP or FIX latex-straps

· Place the LOOP body in such a way, that the stone is able to lay flat on the ground with the body fitted on its side and parallel to the ground

· Use clip for quick assembly/disassembly

· Use pearl to prevent entanglement between swivel and assembly

Product video can be found at: www.fishstone.de/products/loop

Example below with FIX:

